

ICS IN SYSTEM CONTROL SERVO CIRCUIT

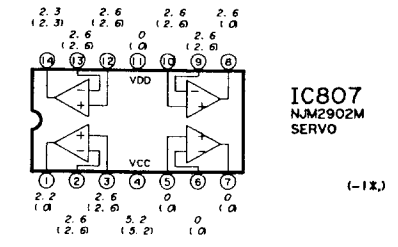

Values in ( ) are for the playback mode

OVERALL SCHEMATIC DIAGRAM (VCR Section)

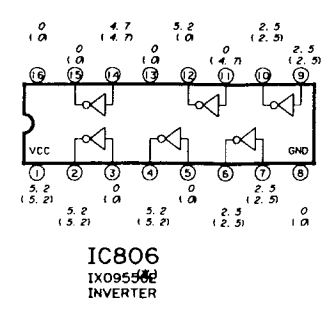
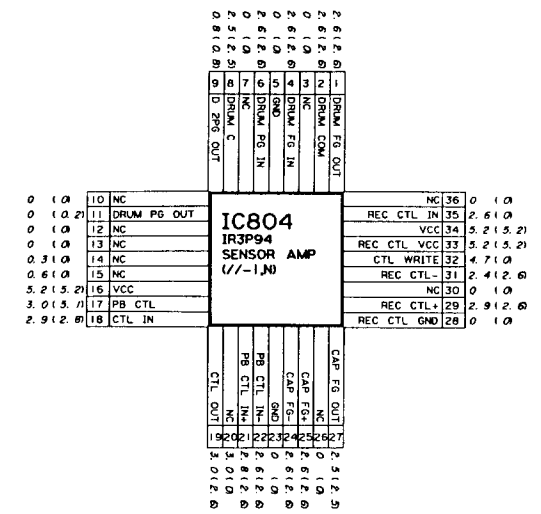
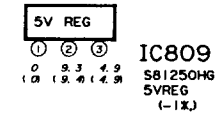
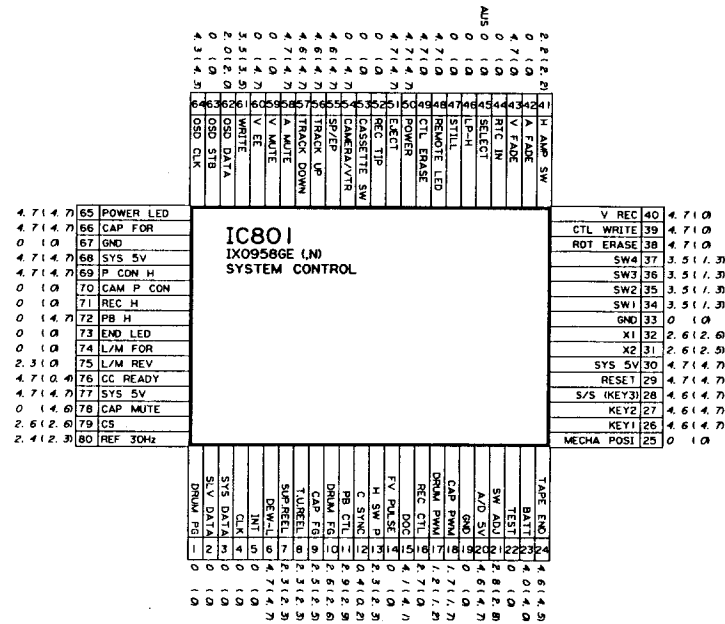
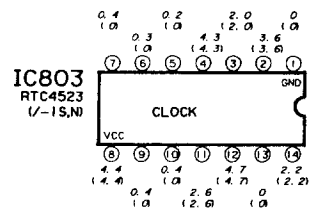
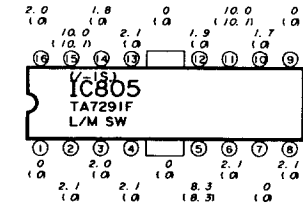
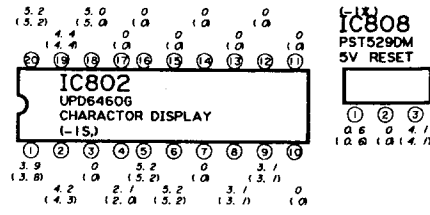
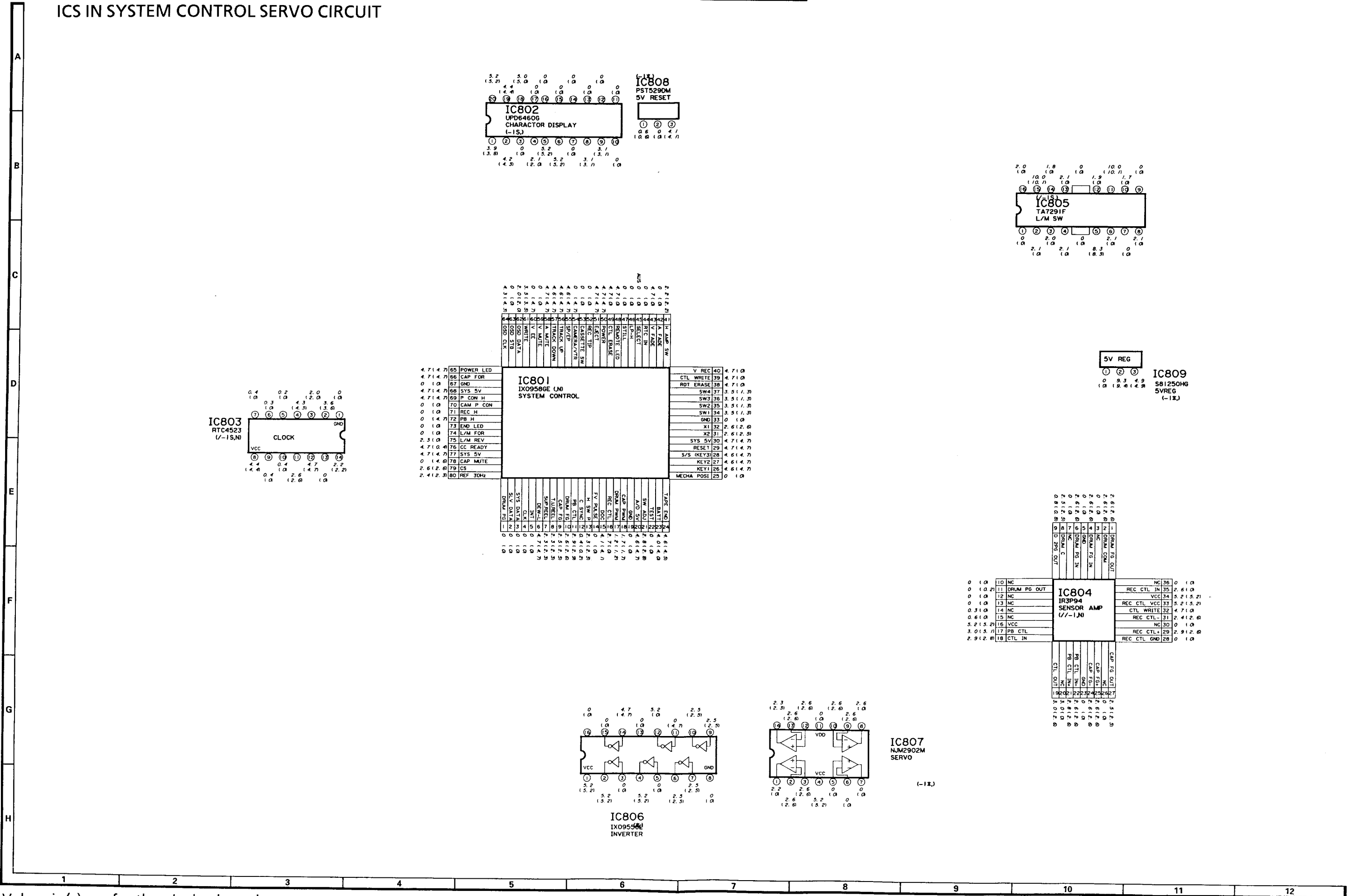
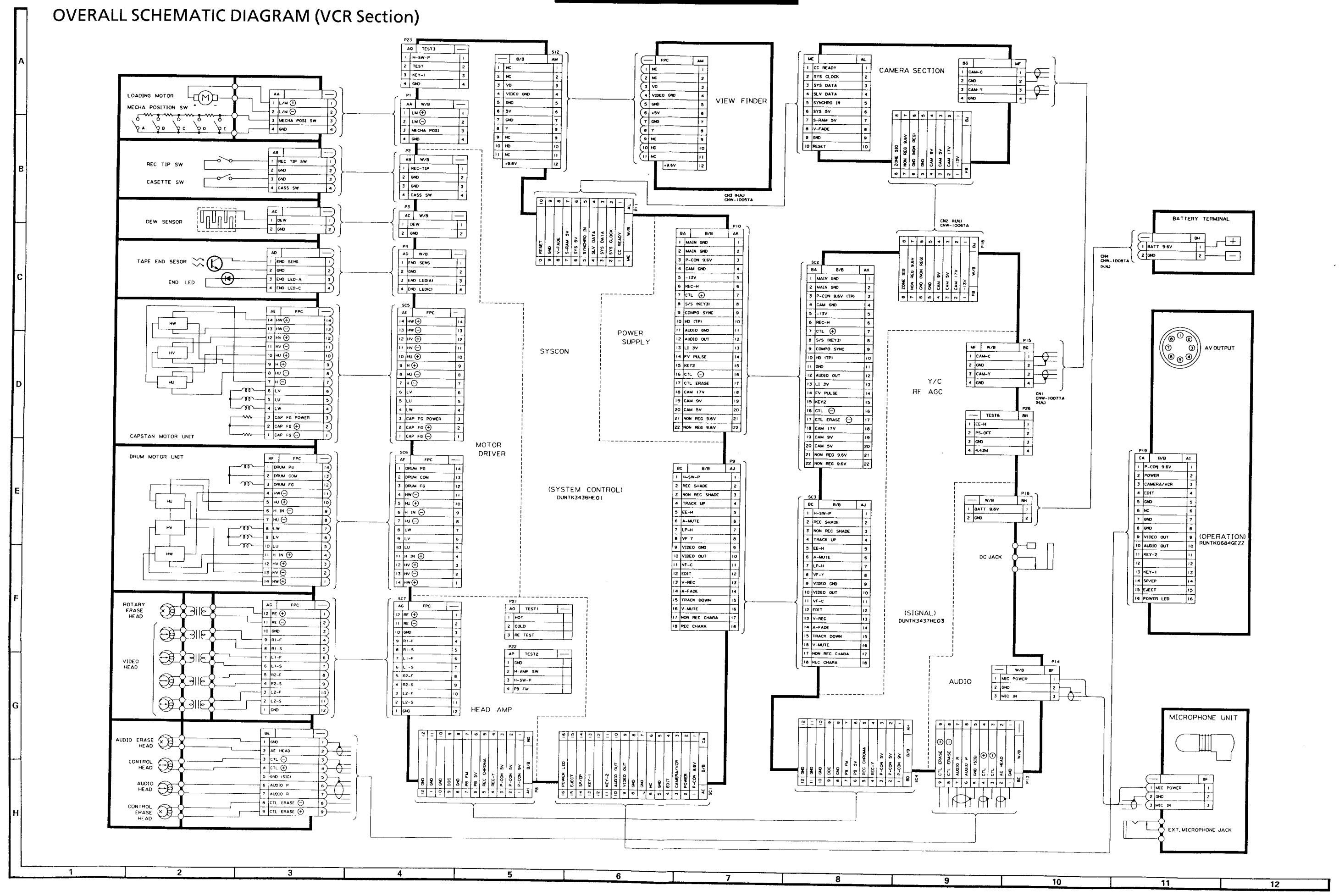

# AUDIO CIRCUIT SCHEMATIC DIAGRAM

REC audio signal  
PB audio signal  
EE audio signal

**▲ AND SHADED COMPONENTS = SAFETY RELATED PARTS**

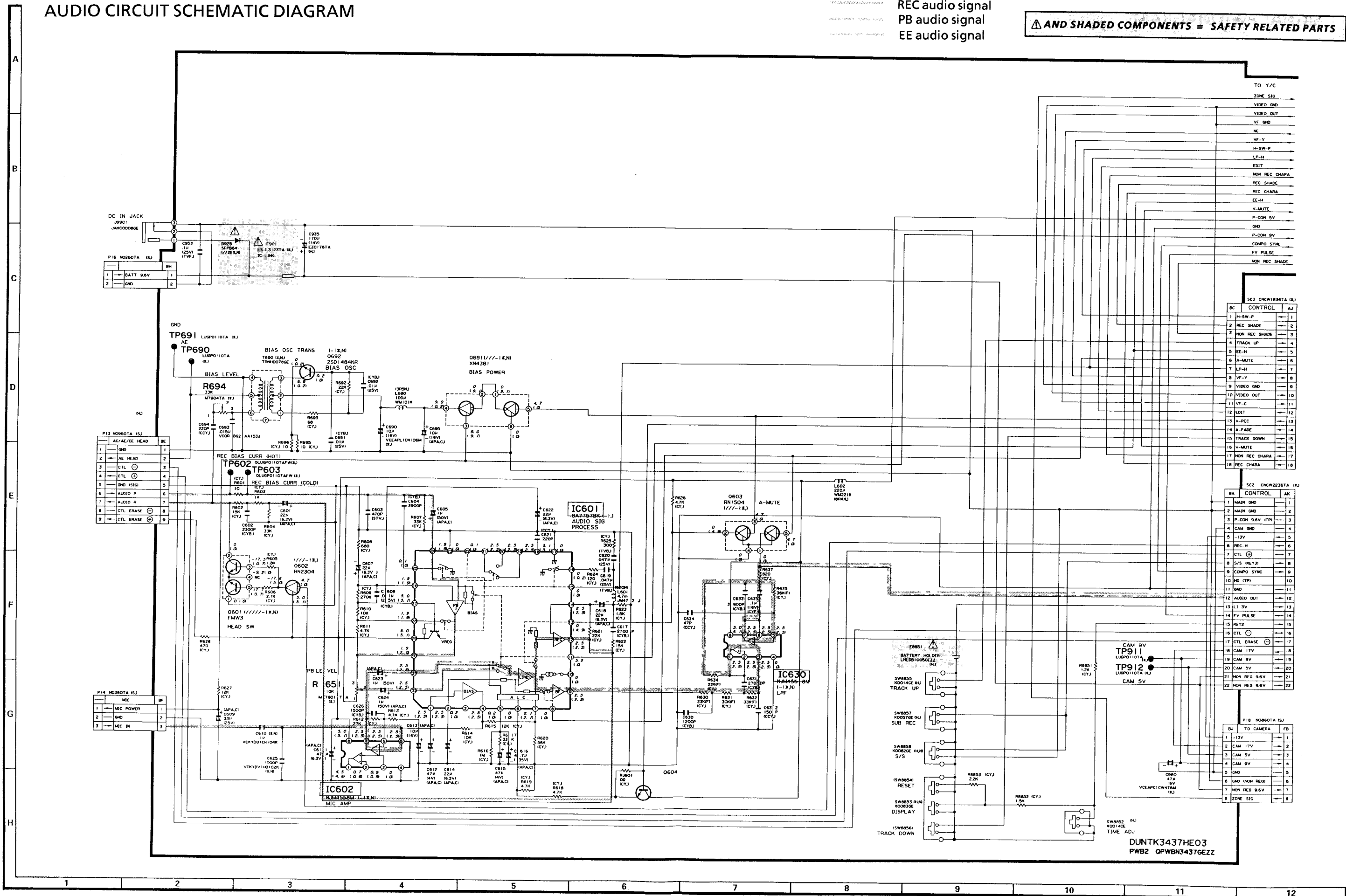

TO Y/C

|               |  |
|---------------|--|
| ZONE SIG      |  |
| VIDEO GND     |  |
| VIDEO OUT     |  |
| VF GND        |  |
| VF-Y          |  |
| H-SW-P        |  |
| LP-H          |  |
| EDIT          |  |
| NON REC CHARA |  |
| REC SHADE     |  |
| REC CHARA     |  |
| EE-H          |  |
| V-MUTE        |  |
| P-CON 5V      |  |
| GND           |  |
| P-CON 9V      |  |
| COMPO SYNC    |  |
| FV PULSE      |  |
| NON REC SHADE |  |

SC3 CNW1836TA (BJ)

| BC | CONTROL       | AJ |
|----|---------------|----|
| 1  | H-SW-P        | 1  |
| 2  | REC SHADE     | 2  |
| 3  | NON REC SHADE | 3  |
| 4  | TRACK UP      | 4  |
| 5  | EE-H          | 5  |
| 6  | A-MUTE        | 6  |
| 7  | LP-H          | 7  |
| 8  | VF-Y          | 8  |
| 9  | VIDEO GND     | 9  |
| 10 | VIDEO OUT     | 10 |
| 11 | VF-C          | 11 |
| 12 | EDIT          | 12 |
| 13 | V-REC         | 13 |
| 14 | A-FADE        | 14 |
| 15 | TRACK DOWN    | 15 |
| 16 | V-MUTE        | 16 |
| 17 | NON REC CHARA | 17 |
| 18 | REC CHARA     | 18 |

SC2 CNW2236TA (BJ)

| BA | CONTROL         | AK |
|----|-----------------|----|
| 1  | MAIN GND        | 1  |
| 2  | MAIN GND        | 2  |
| 3  | P-CON 9.6V (TP) | 3  |
| 4  | CAM GND         | 4  |
| 5  | -12V            | 5  |
| 6  | REC-H           | 6  |
| 7  | CTL (E)         | 7  |
| 8  | S/S KEY2        | 8  |
| 9  | COMPO SYNC      | 9  |
| 10 | HD (TP)         | 10 |
| 11 | GND             | 11 |
| 12 | AUDIO OUT       | 12 |
| 13 | L1 3V           | 13 |
| 14 | FV PULSE        | 14 |
| 15 | KEY2            | 15 |
| 16 | CTL (E)         | 16 |
| 17 | CTL ERASE (E)   | 17 |
| 18 | CAM 17V         | 18 |
| 19 | CAM 9V          | 19 |
| 20 | CAM 5V          | 20 |
| 21 | NON REC 9.6V    | 21 |
| 22 | NON REC 9.6V    | 22 |

P18 NO80TA (SJ)

| BU | TO CAMERA     | FB |
|----|---------------|----|
| 1  | -12V          | 1  |
| 2  | CAM 17V       | 2  |
| 3  | CAM 5V        | 3  |
| 4  | CAM 9V        | 4  |
| 5  | GND           | 5  |
| 6  | GND (NON REC) | 6  |
| 7  | NON REC 9.6V  | 7  |
| 8  | ZONE SIG      | 8  |

Values in ( ) are for the playback mode

VIEW FINDER CIRCUIT SCHEMATIC DIAGRAM

Luminance signal

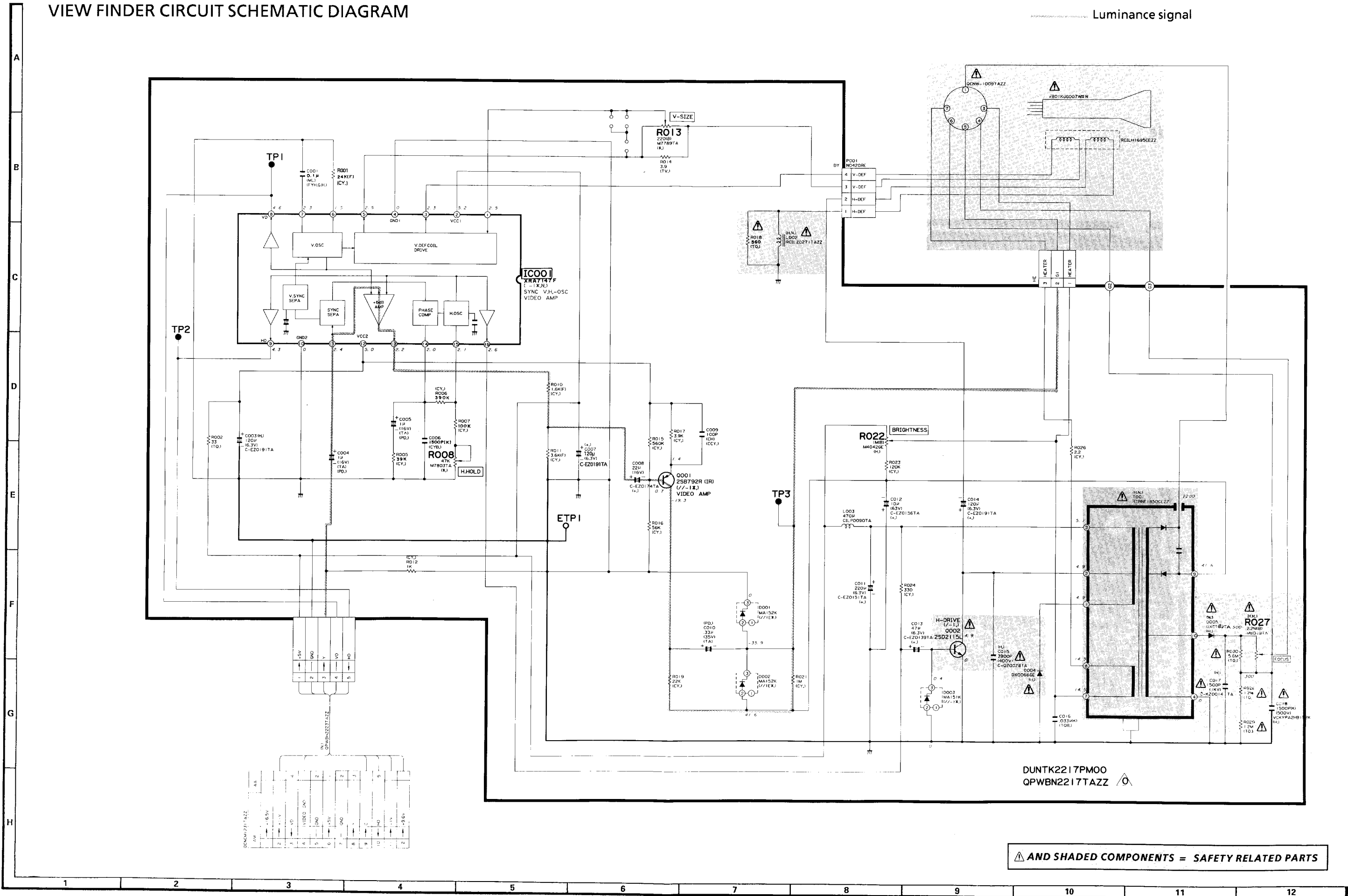

AND SHADED COMPONENTS = SAFETY RELATED PARTS

SENSOR CIRCUIT SCHEMATIC DIAGRAM

Luminance/colour signal

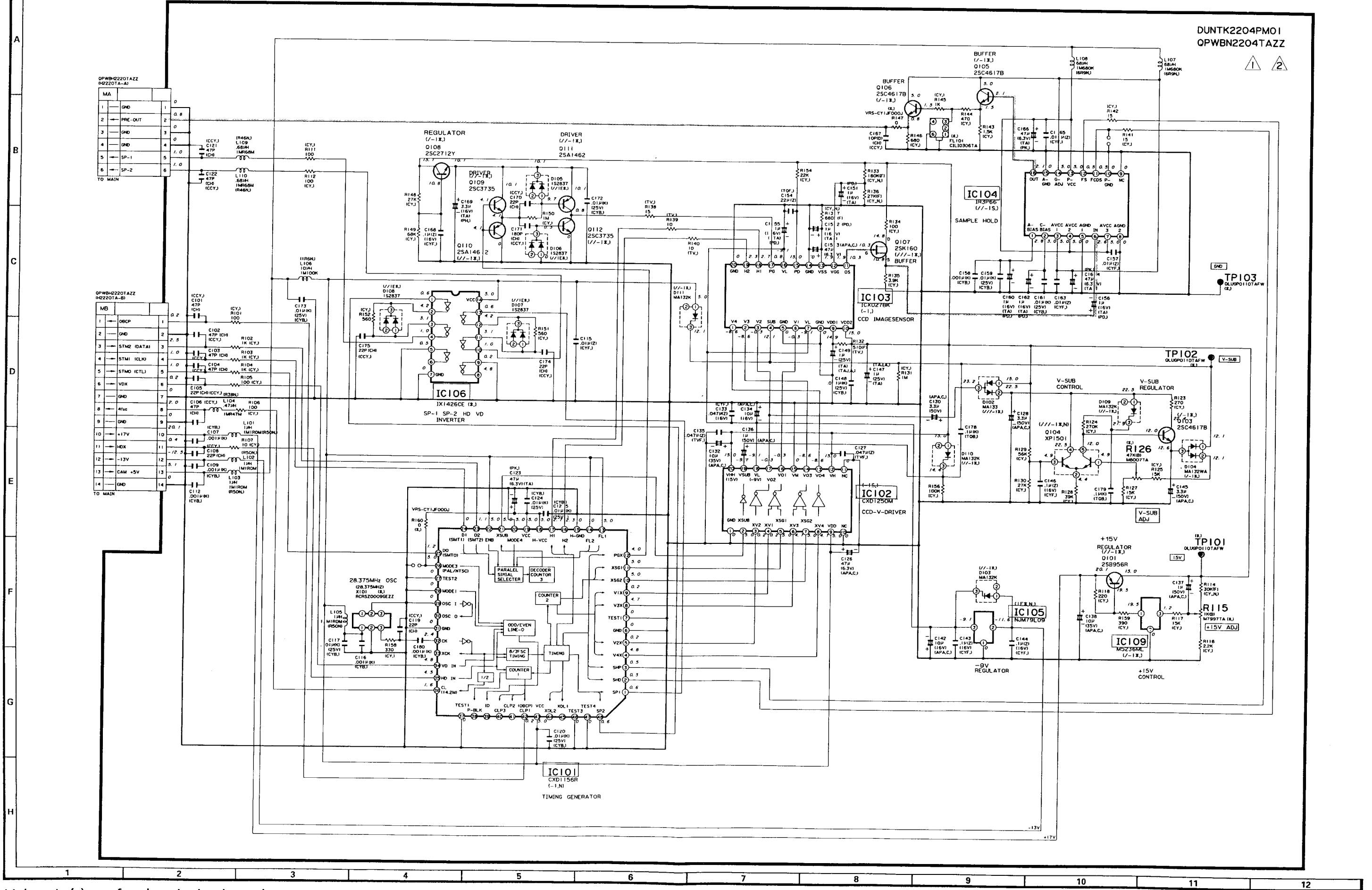

Values in ( ) are for the playback mode

### SSG/ENCODER CIRCUIT SCHEMATIC DIAGRAM

Luminance signal

Colour signal

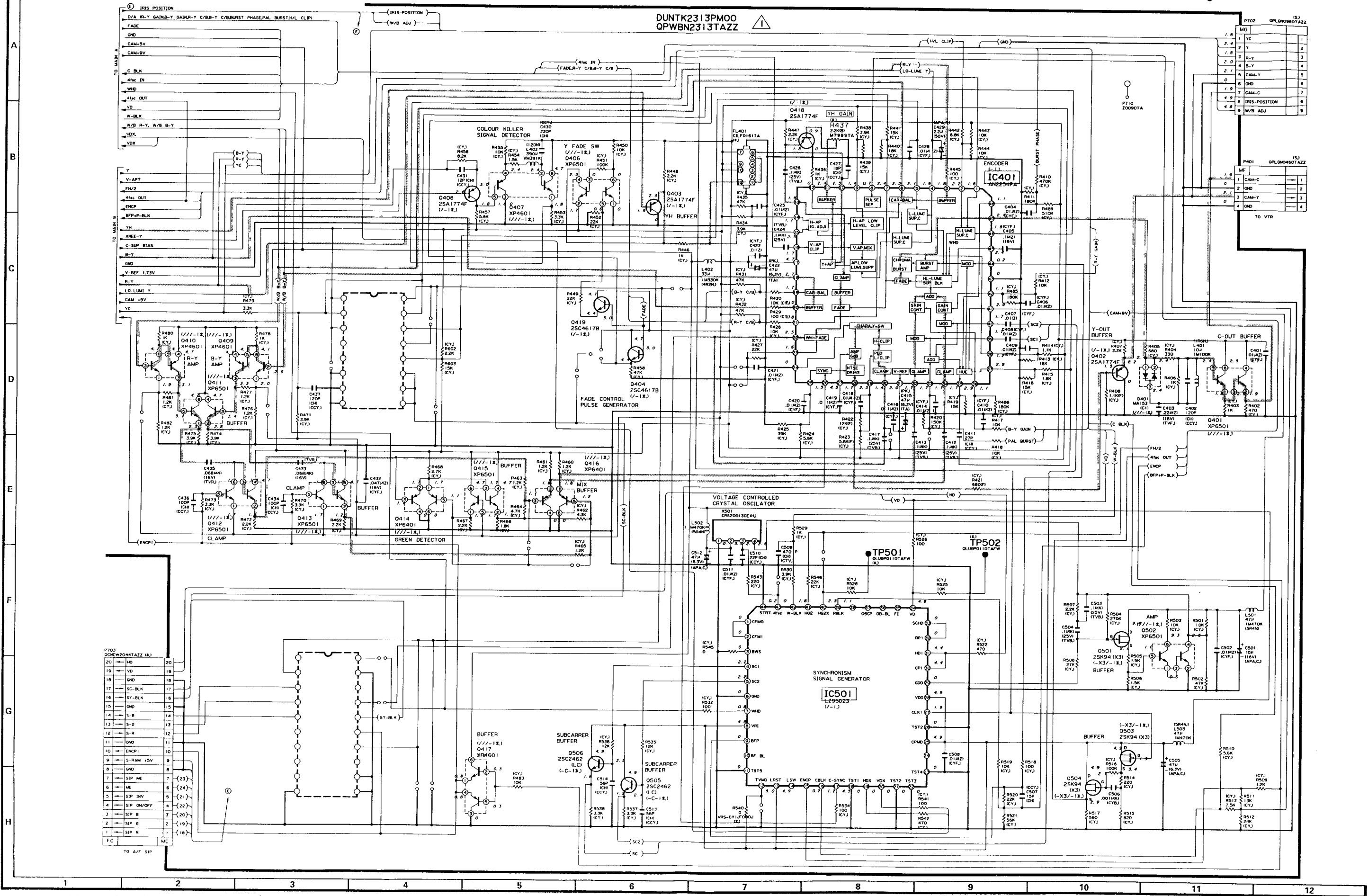

P702 2044TAZZ (8J)

|    |            |        |
|----|------------|--------|
| 20 | HD         | 20     |
| 19 | VD         | 19     |
| 18 | GND        | 18     |
| 17 | SC-BLK     | 17     |
| 16 | SY-BLK     | 16     |
| 15 | GND        | 15     |
| 14 | S-B        | 14     |
| 13 | S-G        | 13     |
| 12 | S-R        | 12     |
| 11 | GND        | 11     |
| 10 | ENCP1      | 10     |
| 9  | S-RAN +5V  | 9      |
| 8  | GND        | 8      |
| 7  | SIP ME     | 7 (23) |
| 6  | ME         | 6 (24) |
| 5  | SIP INV    | 5 (21) |
| 4  | SIP ON/OFF | 4 (22) |
| 3  | SIP B      | 3 (20) |
| 2  | SIP 0      | 2 (19) |
| 1  | SIP R      | 1 (18) |

TO A/F SIP

P702 OPLN0601AZZ

|     |               |     |
|-----|---------------|-----|
| 1.8 | MG            | 1.8 |
| 2.4 | YC            | 2.4 |
| 3   | Y             | 3   |
| 3.8 | R-Y           | 3.8 |
| 4   | B-Y           | 4   |
| 5   | CAM-Y         | 5   |
| 6   | GND           | 6   |
| 7   | CAM-C         | 7   |
| 8   | IRIS-POSITION | 8   |
| 4.8 | W/B ADJ       | 4.8 |

P401 OPLN0601AZZ

|     |       |     |
|-----|-------|-----|
| 1.9 | MF    | 1.9 |
| 2   | CAM-C | 2   |
| 3   | GND   | 3   |
| 4   | CAM-Y | 4   |
| 5   | GND   | 5   |

TO VTR

Values in ( ) are for the playback mode

OPERATION PANEL UNIT CIRCUIT SCHEMATIC DIAGRAM

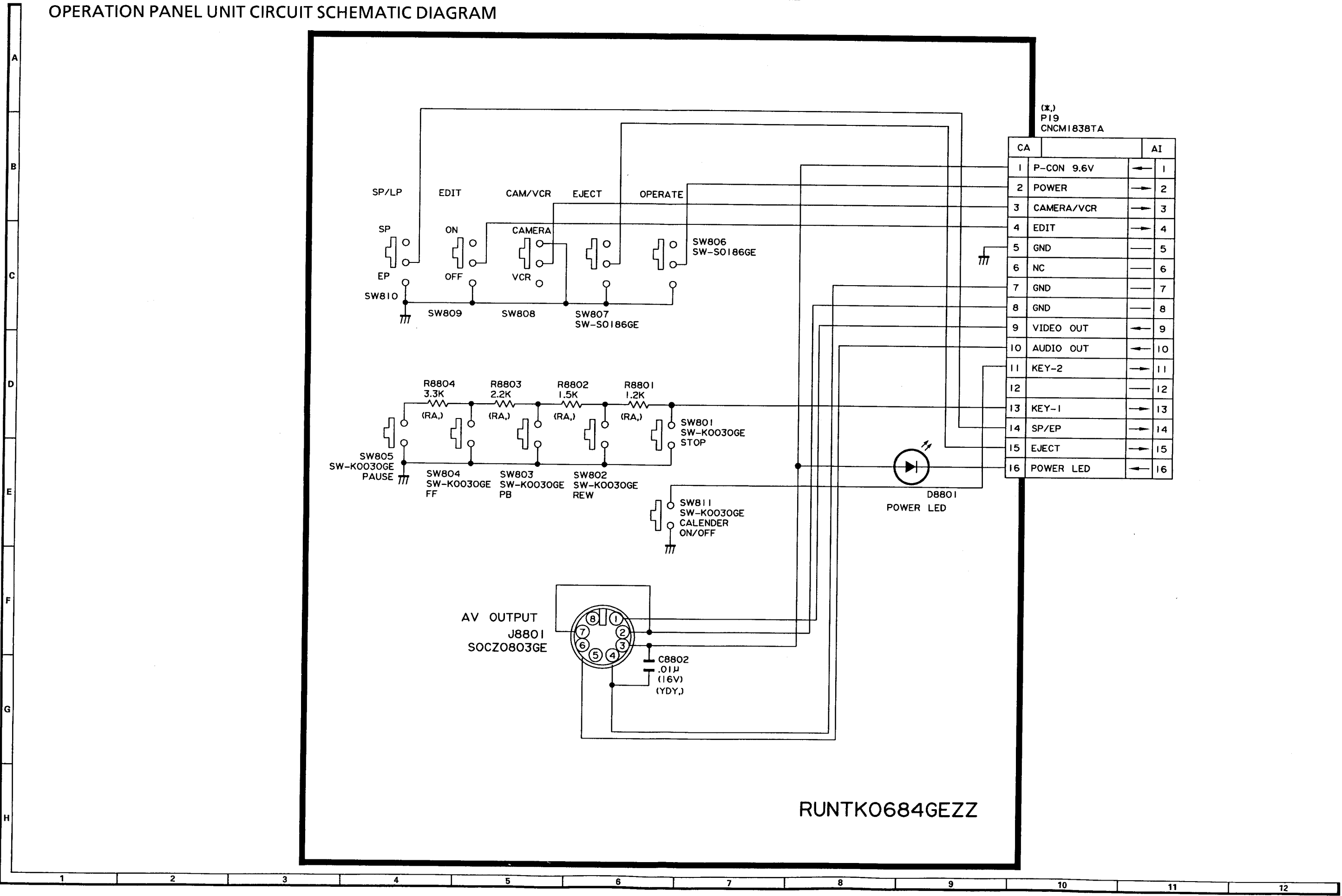

(X.)  
P19  
CNCM1838TA

| CA |            | AI |
|----|------------|----|
| 1  | P-CON 9.6V | 1  |
| 2  | POWER      | 2  |
| 3  | CAMERA/VCR | 3  |
| 4  | EDIT       | 4  |
| 5  | GND        | 5  |
| 6  | NC         | 6  |
| 7  | GND        | 7  |
| 8  | GND        | 8  |
| 9  | VIDEO OUT  | 9  |
| 10 | AUDIO OUT  | 10 |
| 11 | KEY-2      | 11 |
| 12 |            | 12 |
| 13 | KEY-1      | 13 |
| 14 | SP/EP      | 14 |
| 15 | EJECT      | 15 |
| 16 | POWER LED  | 16 |

RUNTK0684GEZZ